

*Hallmark  
Elementary  
Pensacola, Florida*

**Danny A. Zimmern**  
Realtor / Sales Associate

Scoggins III, Inc.  
124 E. Wright Street  
Pensacola, Florida 32502

Phone: 850-434-7777  
Cell: 850-232-1944  
Fax: 850-434-7780

[dannyzuf@aol.com](mailto:dannyzuf@aol.com)



## **DISCLAIMER**

All square footage, dimensions, acreage amounts, and other descriptive information contained in this Property Information Package are based upon information provided by others including: the Sellers, Seller's Consultants, or Seller's Agents and is believed to be correct; however, Purchaser and/or Purchaser's Agent/Broker shall bear total and complete responsibility to confirm any and all information contained herein and shall only rely on that independent investigation and verification. Scoggins III, Inc nor any of its agents, staff or employees, shall not be responsible or liable for the reliability of the information contained herein, nor in any way if the Seller fails to honor any bid or refuses to or cannot close title in accordance with the winning bid or contract entered in respect thereof. All information contained in these materials was derived from sources believed to be correct, but is not guaranteed. This offer is not available to residents of any state in which this real estate is not in compliance with the real estate laws or other laws of that state.



Parcel: 00-0S-00-9080-001-093

Zoning: C-3

Building Size: 38,895 +/--square feet

Land Size: 5.1+/- Acres (Total)

Property Overview: The main building was built in 1936 and contains approximately 28,330 +/- square feet. The property has 3 buildings total. The Media Center building was built in 1999 and contains approximately 8373+/- square feet. 2007 Appraisal available for review at Scoggins III, Inc. email [dannyzuf@aol.com](mailto:dannyzuf@aol.com)

***2007 Appraised Value \$1,900,000***



# Aerial



**Hallmark Elementary School Overview**  
**115 South E Street**

Parcel ID: 00-0S-00-9080-001-093

Year Built: Approximately 1936

Land Size: Approximately 5 +/- Acres

Improvements: 38,895 +/- Square Feet Total of 3 buildings

Building construction: Masonry exterior over steel frame or similar strength concrete block bearing walls.

Flooring: Composition tile flooring.

Walls: Painted masonry walls.

Roof: Built up membrane system

Parking: Asphalt parking with concrete stop blocks to accommodate 40 vehicles

Fencing: 4' Chain Link

Zoning: P

Utilities: Connected to municipal water, sanitary sewerage, electricity and Telephone.

Assessed Value: \$1,525,604

Annual Taxes: BASED ON MILLAGE RATE: 19.1260  
(currently exempt)

# Site / Floor Plan

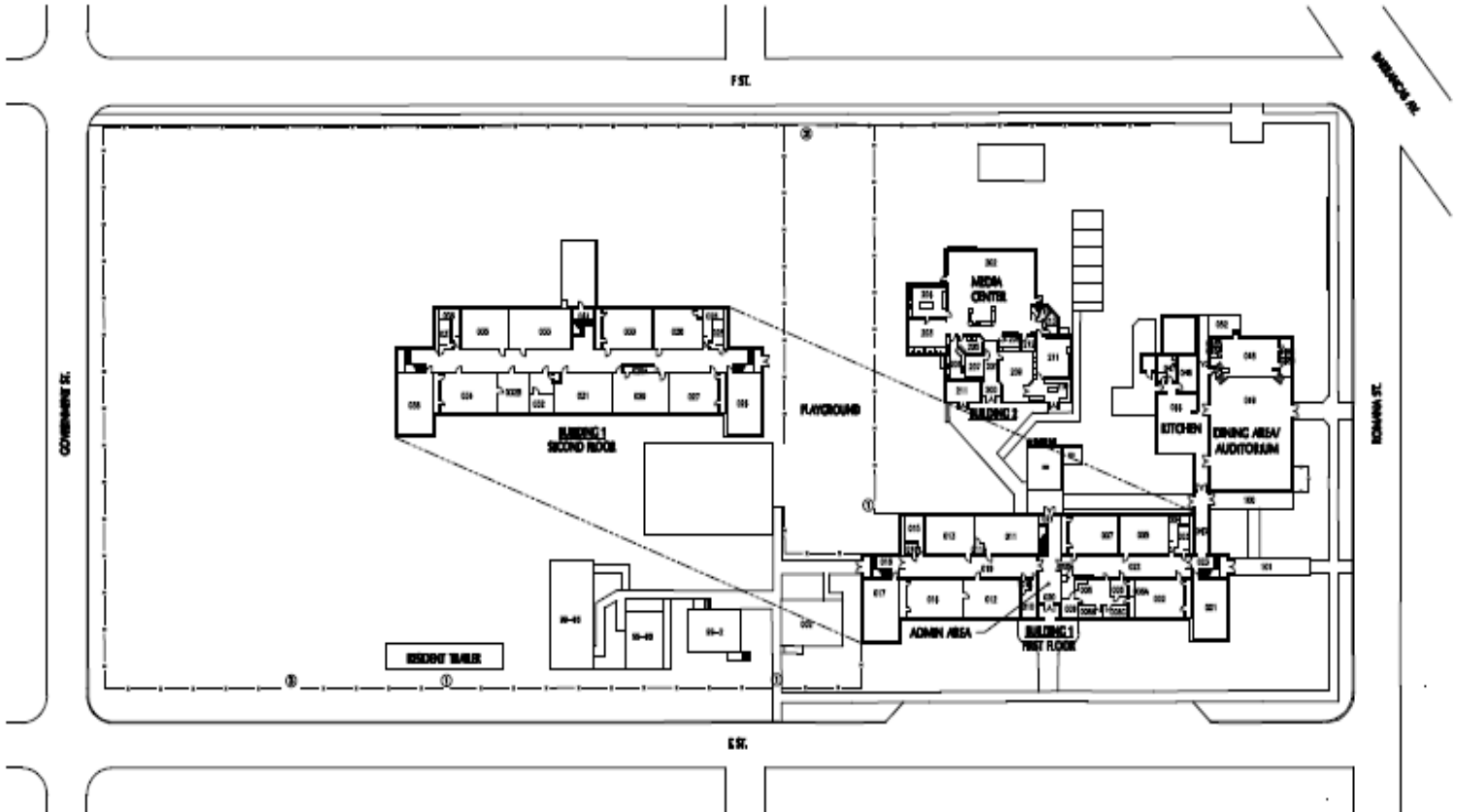

## HALLMARK ELEMENTARY SCHOOL - SITE PLAN

SCALE: 1"=30'-0"

115 SOUTH E STREET, PENSACOLA, FL 32507 (850)886-8888

- GATE LEGEND**
- ① DRILL TRAINING GATE
  - ② DRILL TRAINING GATE WITH CAN-BOY TROOPERS
  - ③ BOWLING TRAINING GATE
  - ④ BOWLING TRAINING GATE WITH CAN-BOY TROOPERS
  - ⑤ BELLINI GATE

# Zoning Overview



# Legal Description

Escambia County Property Appraiser  
**00S009080001093 - Full Legal Description**

LTS 1 TO 26 BLK 93 ALSO LTS 1 TO 26 BLK 112 MAXENT TRACT OR 35-49 CA 103